

All information contained in this document is the intellectual property of STIDD Systems, Inc. and shall not be released, performed, displayed, duplicated, used, or disclosed, in whole or in part, within or outside the receiving party for any purpose other than to evaluate a document from STIDD Systems, Inc. No rights are conveyed to the receiving party or any others to use any intellectual property contained in this document in any manner. All US Government recipients shall protect all information in this document as prescribed by DFARS 252.227-7016. The information subject to this restriction is contained in every page of this document.  
**WARNING:** This document may contain technical data subject to the United States Code of Federal Regulations Chapter 22, International Traffic in Arms Regulations (ITAR). The information herein shall not be exported or made available to any party other than the designated recipient without the express written permission of STIDD Systems, Inc. Violations of these export laws are subject to severe criminal penalties.

REVISIONS					
ZONE	REV	CLASS	DESCRIPTION	DATE	APPROVED
N/A	-	N/A	INITIAL RELEASE	6/23/2011	A.SCHORDINE
8D	A	3	ADDED ROTATION ENVELOPE INFO	5/10/2013	A.SCHORDINE

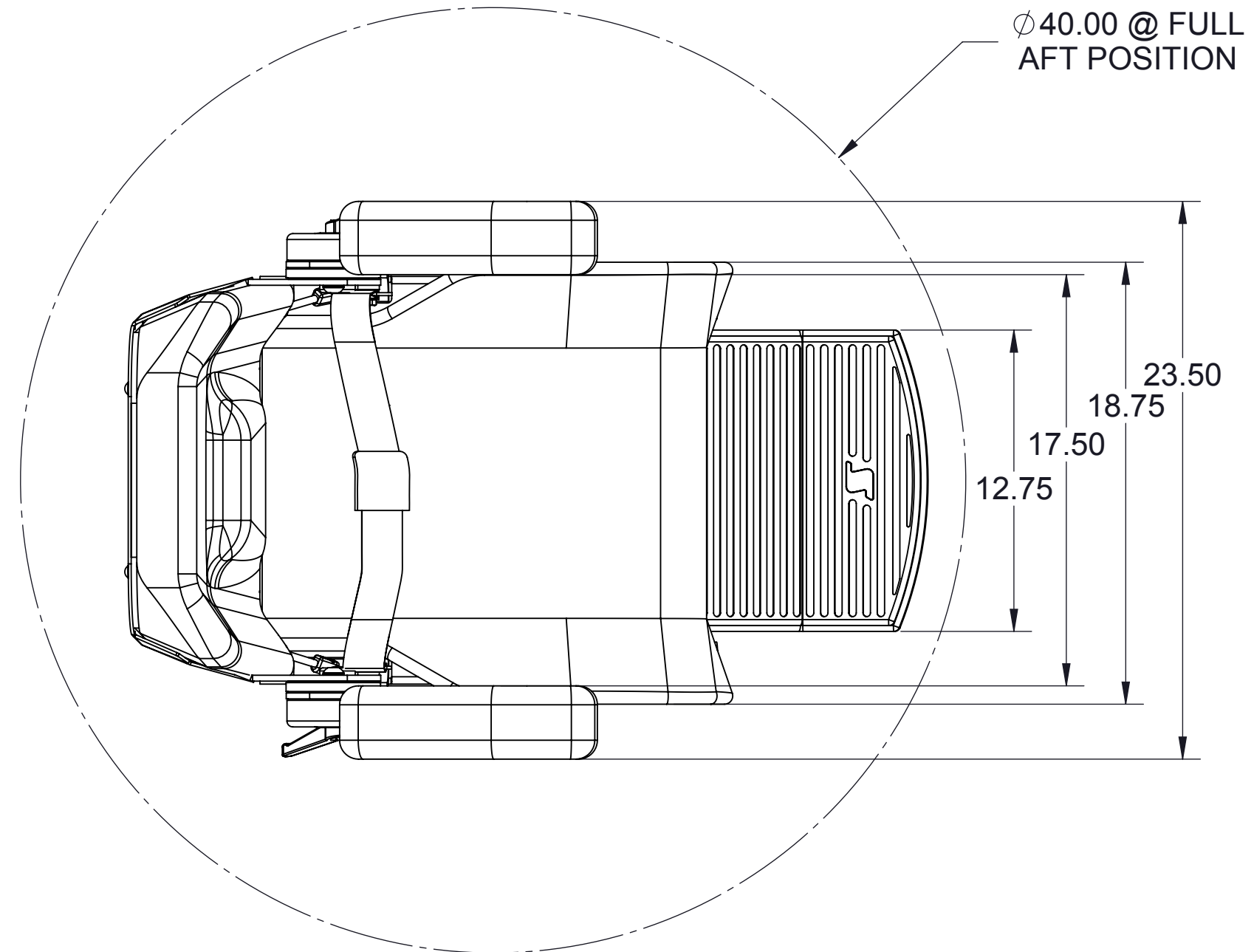

**500N-V5 TECHNICAL SPECIFICATIONS:**

**MOUNTING INFORMATION**

- DECKPLATE TO VESSEL: EIGHT 3/8" DIA. BOLTS ON 11" DIA. BOLT CIRCLE
- DECKPLATE TO PEDESTAL: EIGHT 5/16-18 FLAT, SOCKET HEAD BOLTS ON 11" BOLT CIRCLE

**SHOCK MITIGATION SYSTEM**

- STROKE: 4"
- NITROGEN DIAPHRAGM ALUMINUM COIL-OVER SHOCK ABSORBER
- COLD-WOUND PRE-HEAT TREATED SAE 9254 CHROME SILICON COIL SPRING
- 10-POSITION REBOUND DAMPING ADJUSTMENT

**RATED LOADING**

- PASSENGER WEIGHT: 250LB
- MAXIMUM G-FORCE SHOCK LOAD\*: 7G
- (\*VERTICAL SHOCK, DURATION APPROX 1.5S, W/ 250LB PASSENGER)

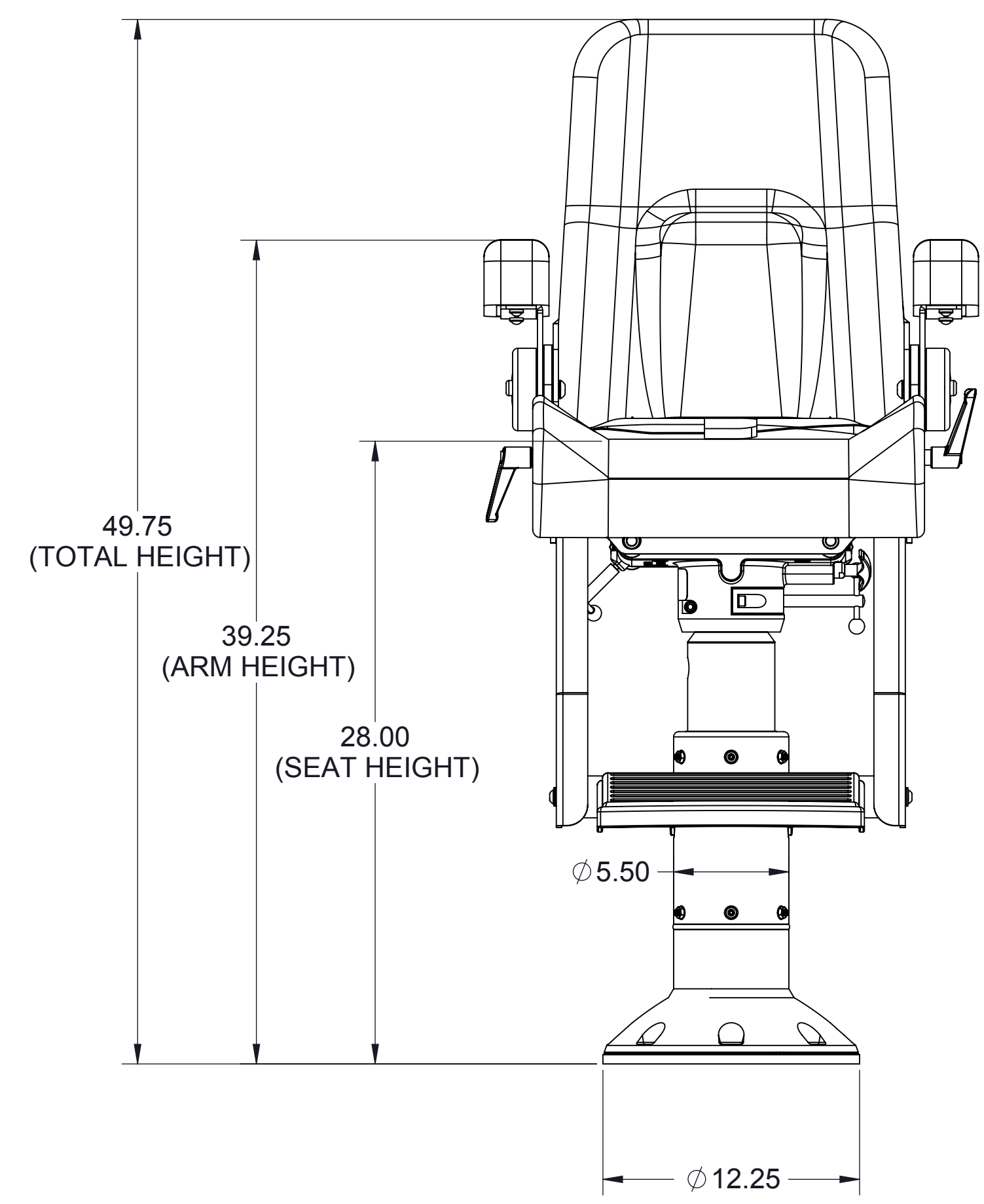
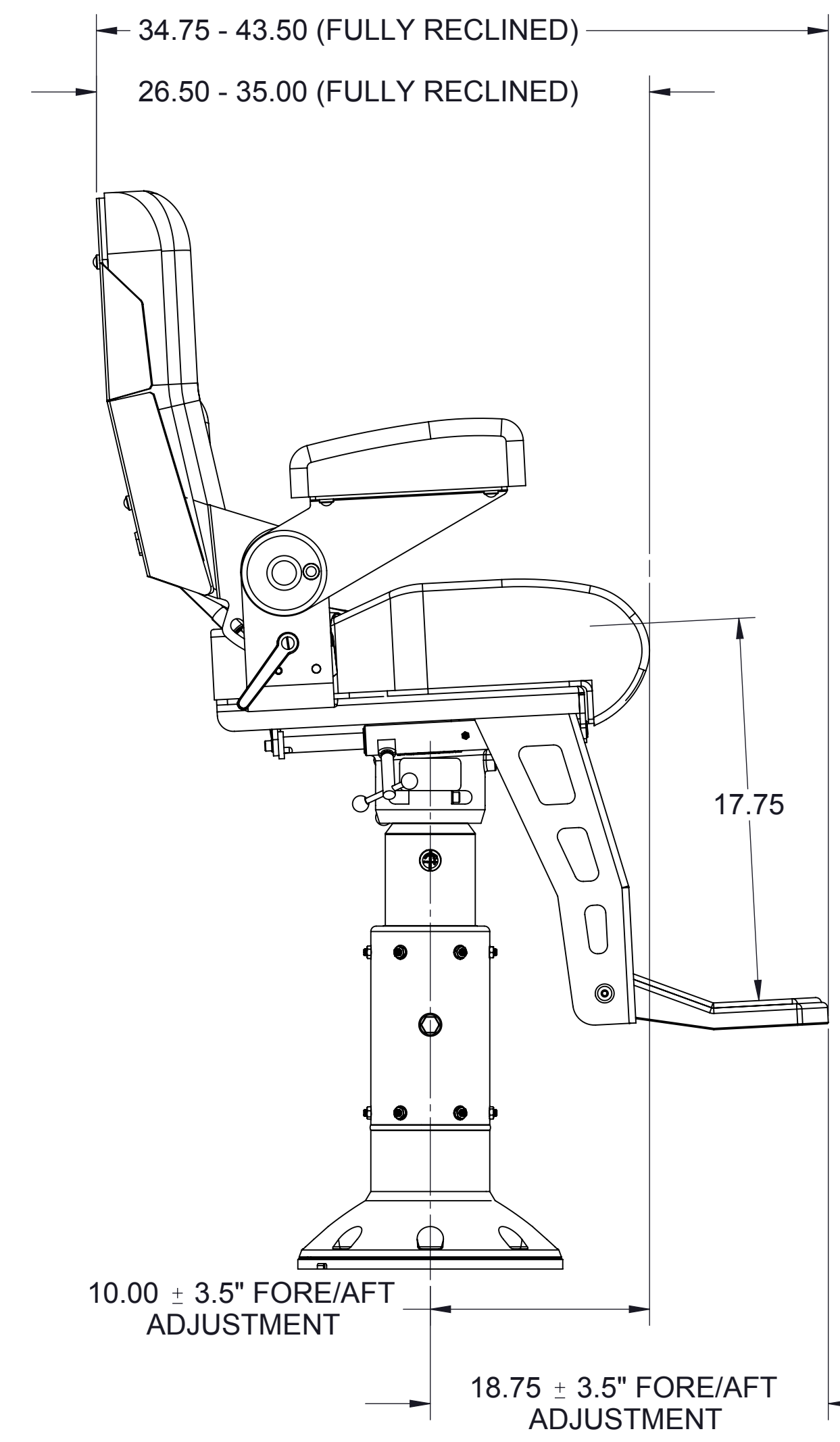

ORIGINATOR	DATE
A.SCHORDINE	6/23/2011
APPROVED	DATE
R.DIGREGORIO	6/23/2011
UNLESS OTHERWISE SPECIFIED:	
· INTERPRET DWG IAW ANSI Y14.5M	
· DIMENSIONS ARE IN INCHES	
· BREAK ALL SHARP EDGES	
· DRAWING TOLERANCES ARE:	
* ANGLES : 1°	
* 0.XX : 0.01	
* 0.XXX : 0.005	
MATERIAL	N/A
WEIGHT (lbs)	92.724



**STIDD SYSTEMS INC.**  
 220 CARPENTER STREET  
 GREENPORT, NY 11944  
 USA · (631) 477-2400

TITLE  
**500 NARROW LOWBACK W/ V5 PEDESTAL**

SIZE	CAGE CODE	DWG No.	REV
D	0W5E3	500N-V5	A
DO NOT SCALE DRAWING WORK FROM DIMENSIONS		SCALE: 1:6	SHEET 1 OF 1